

**FRONT AND LATERAL VIEW**

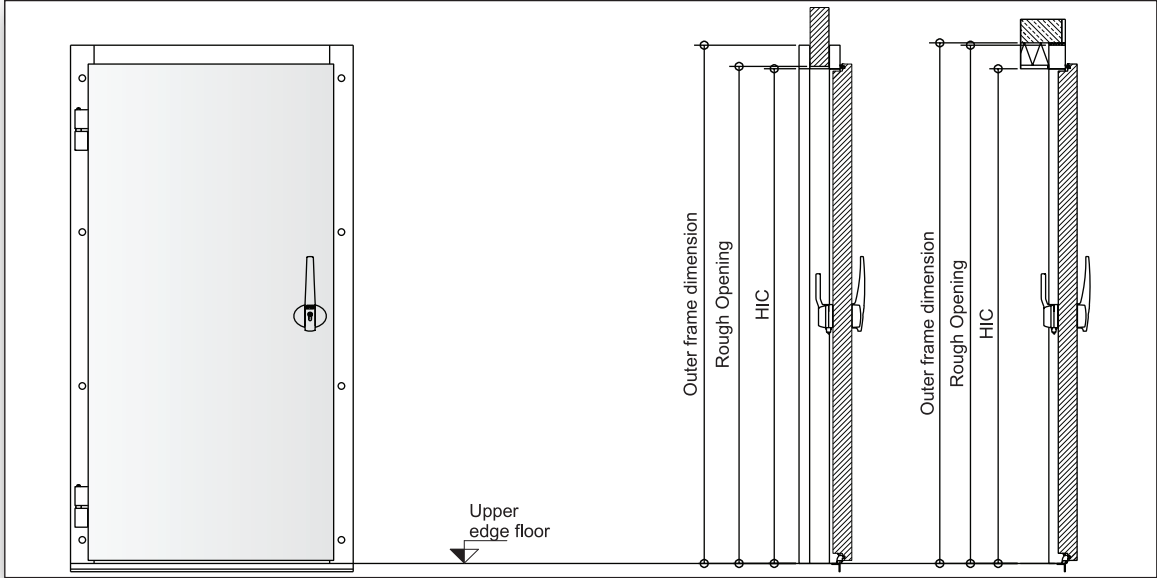

**DETAILS FOR PANEL INSTALLATION LEFT SWING (RIGHT SWING LATERALLY REVERSED)**

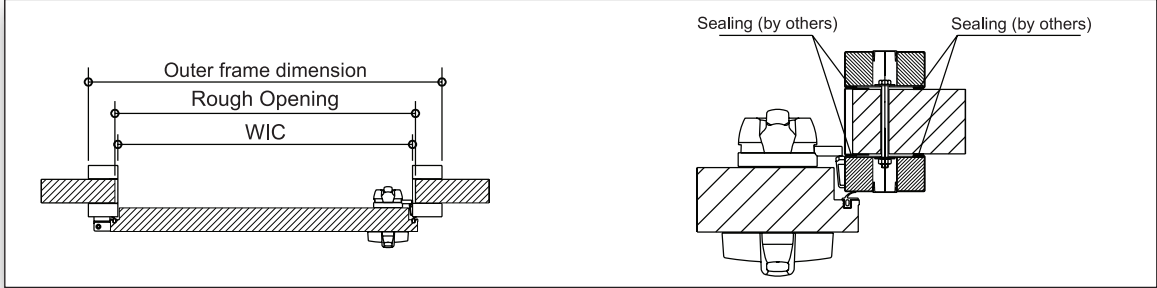

**DETAILS FOR BRICKWORK INSTALLATION LEFT SWING (RIGHT SWING LATERALLY REVERSED)**

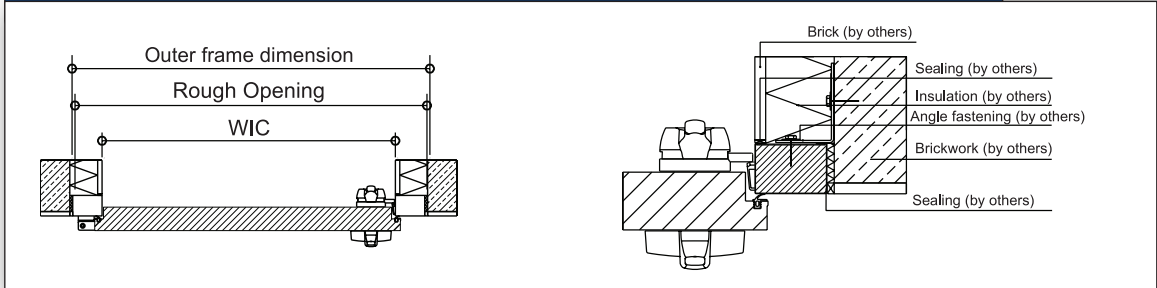

**WARRANTY**

**1 year limited warranty on all parts**

**OPTIONS**

- vision panel
- stainless steel kickplate
- PVC kickplates
- frame material options
- tubular frame
- panic or push/push

General information (warranty): The specifications on this Data Sheet only serve for description purposes. Affirmations with regard to the existence of specific characteristics or a certain purpose of use require a special written agreement in each case. Date: 09/2010 - Subject to technical changes. All dimensions in inches.

General information (warranty): The specifications on this Data Sheet only serve for description purposes. Affirmations with regard to the existence of specific characteristics or a certain purpose of use require a special written agreement in each case. Date: 09/2010 - Subject to technical changes. All dimensions in inches.  
**Important note:** All surfaces are covered with a protective assembly foil which must be immediately removed after installation esp. in the case of sun radiation.

### CHARACTERISTICS

**Field of use:**  
refrigerating rooms, refrigerating store rooms

**Temperature Range:**  
down to 32°F (0°C)

**U-value for door leaf in W/m²K:**      **0,30**

**Dimensions:**  
Clear width (WIC):                      max. 6'  
Clear Height (HIC):                    max. 10'

Further sizes deliverable upon request as special production.



### DOOR LEAF

Door leaf thickness 3.15"  
Foamed with 10# polyurethane hard foam  
CFC and HCFC free

Trilaterally supported by plastic profiles, EPDM sponge rubber sealing resistant to bacteria. In the lower area double rubber sealing.

All seals are easily exchangeable.

### DOOR FRAME

Standard execution:

**Brickwork installation:** metal frame 3.94" x 2.76", foamed with 10# polyurethane hard foam. Sheet same execution as door leaf. With or without threshold, optionally attached, light metal profile threshold at ground level. Ready for installation with wall anchors.  
**Panel installation:** clamp frame 3.94" x 1.77", sheet same execution as door leaf.

**Further options upon request:**

- High Sill

### FORMWORK FOR COATING

Galvanized, grade Z275, anticorrosion class III acc.to DIN 55928.  
Polyester coating, 25 micrometers in industrial colors in accordance with the ems color chart.

**Options:**

- Coating FS3000, especially suitable for use in the food processing industry, physiologically harmless, available in industrial colors.
- Food safe foil coating (LMF), 150 micrometers, physiologically harmless **only suitable for interior use**, color similar to RAL 9001, vertical sheet joint from 0.04".

Stainless steel, 1.4301, non corrosive according to DIN 17440, circular depolishing or brushed longitudinal, vertical sheet joint from 0.055".

Further options upon request.

### HINGES/HANDLES

Standard execution: rising hinges made of stainless steel in plastic interconnection three-dimensional adjustable ems combi handle with 3 keys.

**Further options upon request:**

- press lock "ems-press 2000"
- three point bolting device

Shop Drawing For Fabrication

**KTM1**  
**COOLER ROOM**  
**HINGED DOOR**

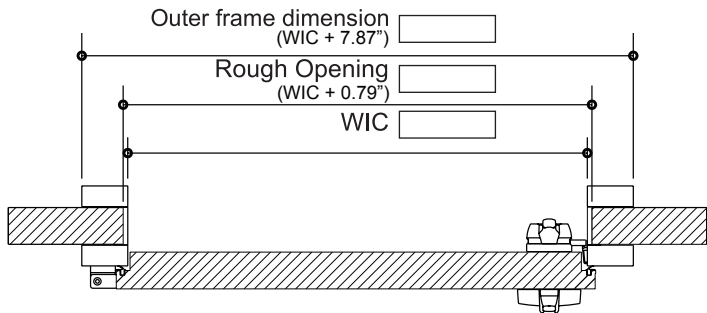
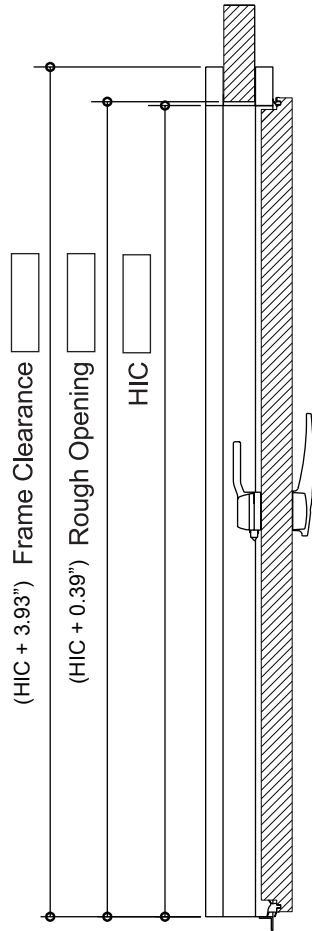
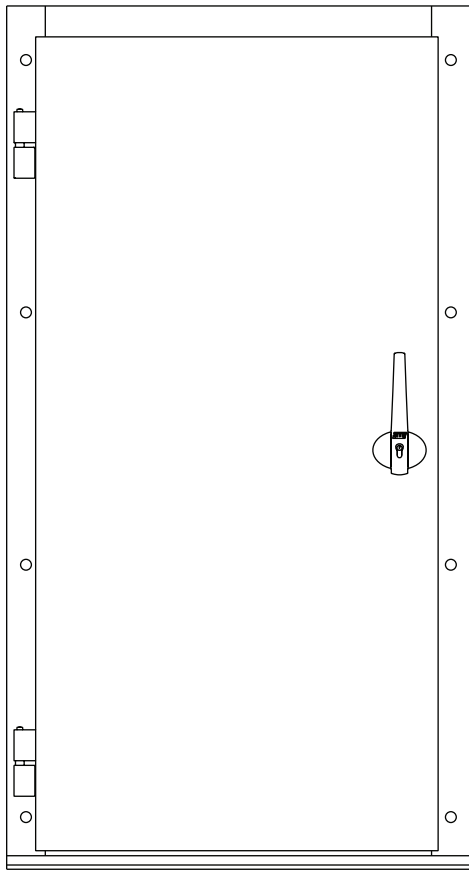

**Changes, Remarks, etc.**

**Door Information**

- Height In Clear \_\_\_\_\_
- Width In Clear \_\_\_\_\_
- Rough Opening Height \_\_\_\_\_
- Rough Opening Width \_\_\_\_\_
- Seal Material  EPDM  Silicone
- Hinged Side  Right  Left
- Door Finish  White  Stainless
- Stainless Finish  Circular  Brushed

**Frame Information**

- Frame Clearance Height \_\_\_\_\_
- Frame Clearance Width \_\_\_\_\_
- Frame Style  2 pc  Block
- Clamp Rough Opening \_\_\_\_\_
- Flat Frame Finished Opening \_\_\_\_\_
- Wall Thickness \_\_\_\_\_
- Pocket Holes  Yes  No
- Frame Material  PVC White Clad  
 PVC S/S Clad  
 Foamed  
 Stainless Steel

**Options**

- Push/Pull Handle  Yes  No
- Handle Package  Plastic Handle  
 Stainless Handle
- Mortise Lock (Stainless Steel)  Yes
- Panic Bar  W/Exterior Access  
 W/Out Exterior Access
- Kick Plate  Yes  No
- Door Closer  Yes  No
- Window  Yes  No
- Size \_\_\_\_\_

**Ordering Information**

- Door Number \_\_\_\_\_
- Quantity \_\_\_\_\_
- Job \_\_\_\_\_
- P.O. Number \_\_\_\_\_
- Date Ordered \_\_\_\_\_

<http://www.steelworksandsupply.com>  
 Phone: (919) 639 - 3002

\_\_\_ Approved \_\_\_ Approved w/changes (use box if needed)

INSULATED DOORS

Signature \_\_\_\_\_

Date \_\_\_\_\_