

FRONT AND LATERAL VIEW

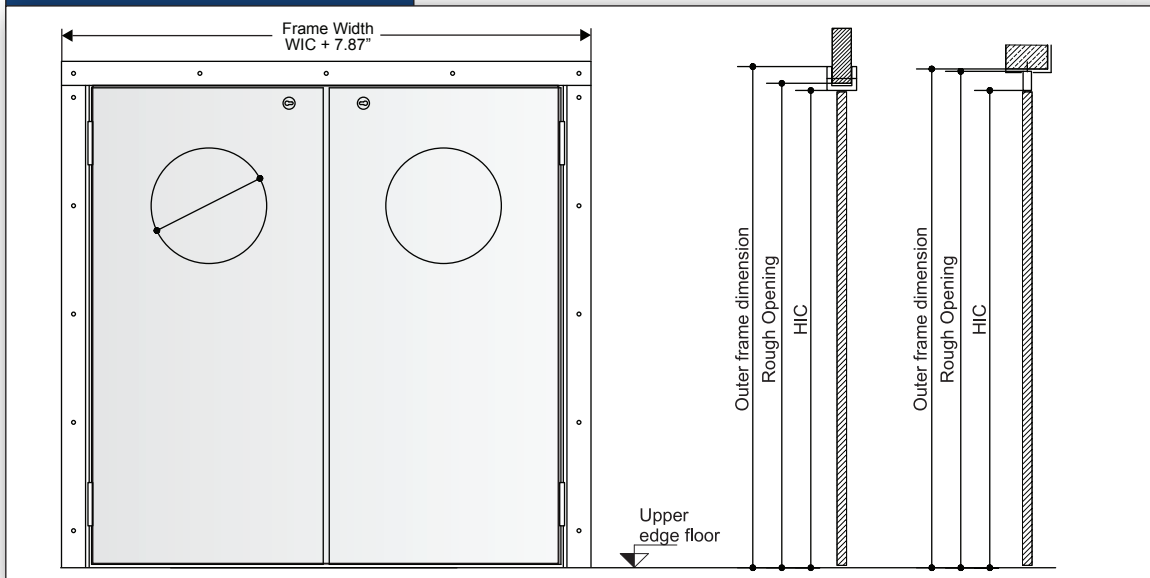

DOUBLE LEAF  
**TRAFFIC DOOR**

DETAILS FOR PANEL INSTALLATION

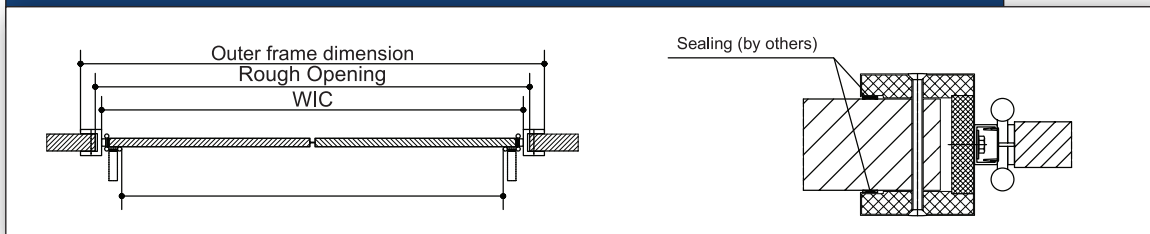

DETAILS FOR BRICKWORK INSTALLATION

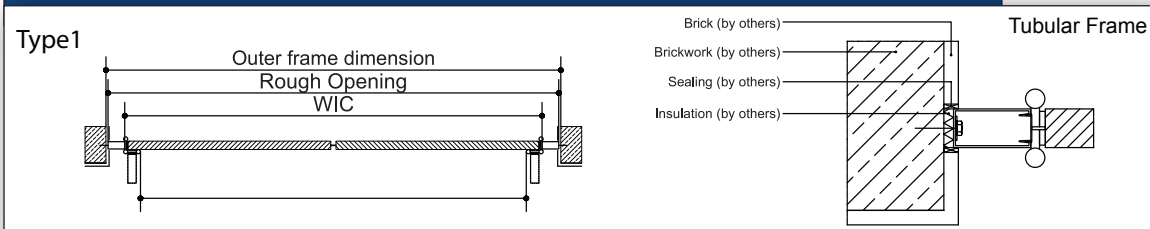

DETAILS FOR BRICKWORK INSTALLATION

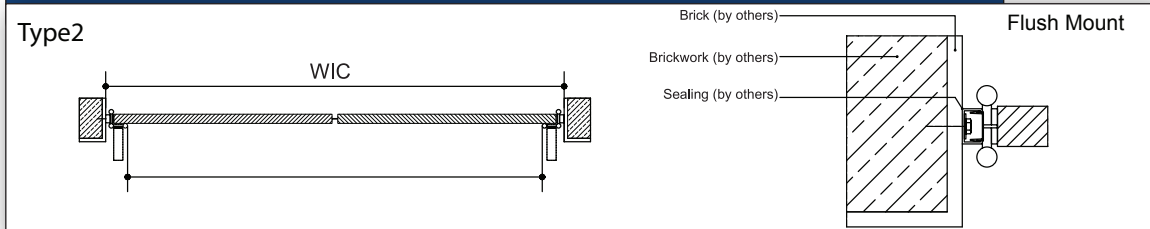

WARRANTY

1 year limited warranty on all parts

OPTIONS

- latch plate lock with cylinder & 3 keys
- vision panels
- kickplates & bumpers

General information (warranty): The specifications on this Data Sheet only serve for description purposes. Affirmations with regard to the existence of specific characteristics or a certain purpose of use require a special written agreement in each case. Date: 09/2010 - Subject to technical changes. All dimensions in inches.

### CHARACTERISTICS

#### Field of use:

- application where a traffic door is needed in areas where:
- cold separation is a must
  - kept at moderate temperatures
  - **Option for Blast Freezer Rooms**

#### Temperature Range:

down to -18.4°F (-28°C)  
down to -40° for Blast Freezer Rooms (see factory)

#### Dimensions:

Clear width (WIC): max. 8'  
Clear Height (HIC): max. 8'

Further sizes deliverable upon request as special production.

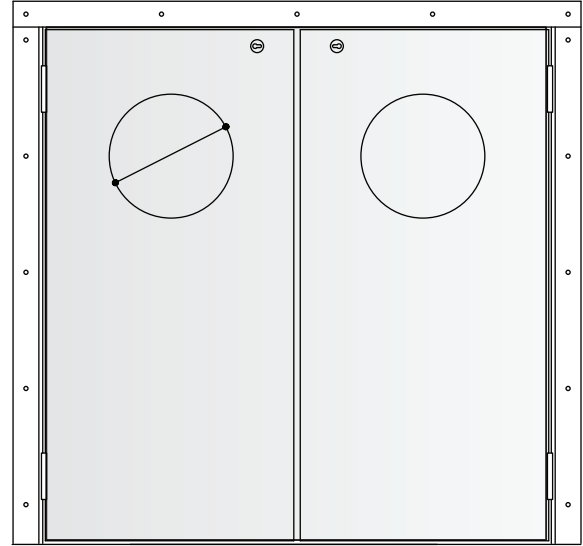

### DOOR LEAF

Door leaf thickness 1.5", (blast freezer room 2.00")  
Foamed with 10# polyurethane hard foam  
CFC and HCFC free

Cold resistant PTK sealing both on hinged and locking side

### DOOR FRAME

#### Door frame in masonry installation:

Type 1: three sided chromium nickel stainless steel tubular frame (3" x 1.5")  
Type 2: flush mount chromium nickel stainless steel tubular frame (3/4" x 1-3/8").

#### Door frame in panel installation:

U-clamp frame (4" x 3/4").

### FORMWORK FOR COATING

Grade Z275, anticorrosion class III acc.to DIN 55928.  
Polyester coating, 25 micrometers in industrial colors in accordance with the ems color chart.

#### Options:

- Coating FS3000, especially suitable for use in the food processing industry, physiologically harmless, available in industrial colors.
- Food safe foil coating (LMF), 150 micrometers, physiologically harmless **only suitable for interior use**, color similar to RAL 9001, vertical sheet joint from 0.04".

Stainless steel, 1.4301, non corrosive according to DIN 17440, circular depolishing or brushed longitudinal, vertical sheet joint from 0.055".

Further options upon request.

### HINGES/HANDLES

Standard execution: 180° working hinges in chromium nickel stainless steel 1.4301

General information (warranty): The specifications on this Data Sheet only serve for description purposes. Affirmations with regard to the existence of specific characteristics or a certain purpose of use require a special written agreement in each case. Date: 09/2010 - Subject to technical changes. All dimensions in inches.

**Important note:** All surfaces are covered with a protective assembly foil which must be immediately removed after installation esp. in the case of sun radiation.

# Shop Drawing For Fabrication

## MPT2 DOUBLE LEAF TRAFFIC DOOR

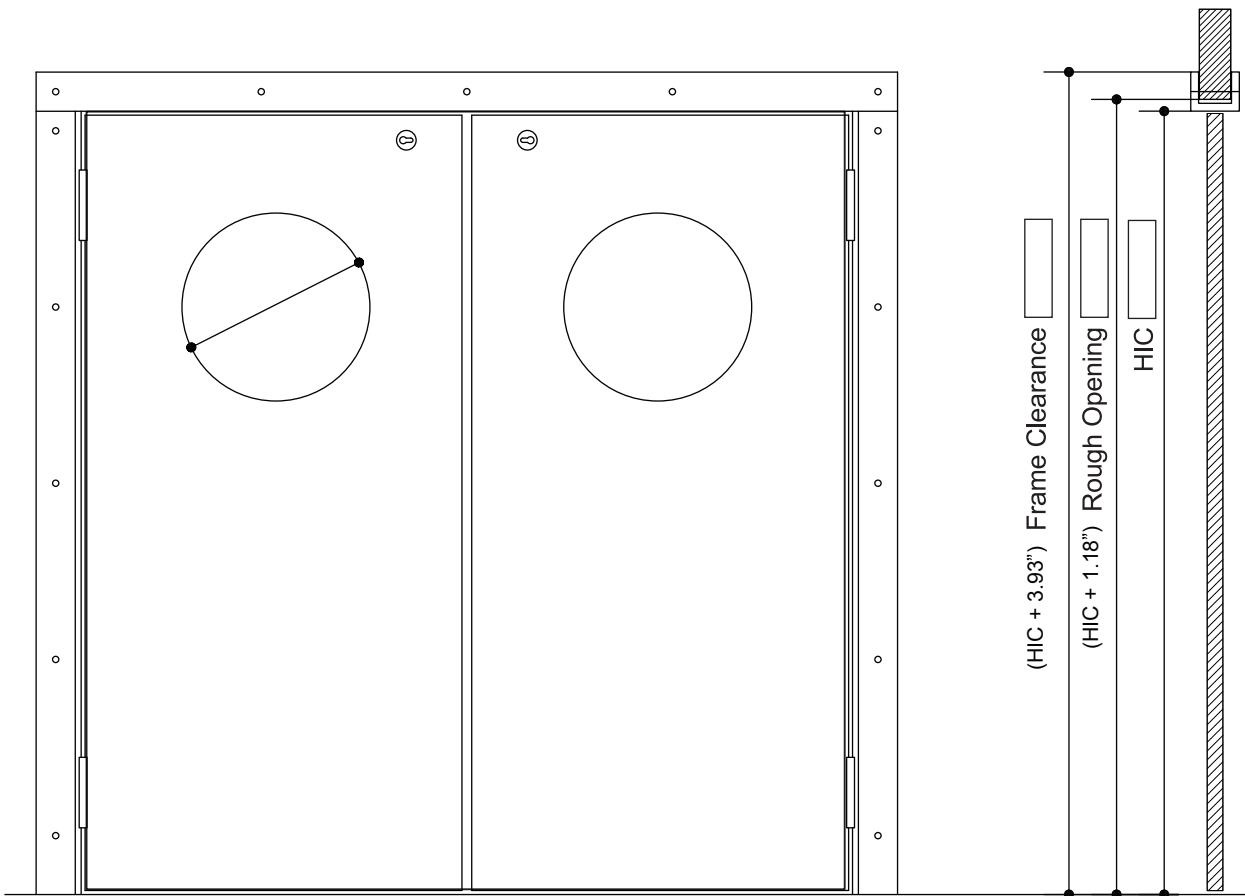

### Door Information

- Height In Clear \_\_\_\_\_
- Width In Clear \_\_\_\_\_
- Rough Opening Height \_\_\_\_\_
- Rough Opening Width \_\_\_\_\_
- Seal Material  EPDM  Silicone
- Hinged Side  Right  Left
- Door Finish  White  Stainless
- Stainless Finish  Circular  Brushed

### Frame Information

- Frame Clearance Height \_\_\_\_\_
- Frame Clearance Width \_\_\_\_\_
- Frame Style  2 pc  Block
- Clamp Rough Opening \_\_\_\_\_
- Flat Frame Finished Opening \_\_\_\_\_
- Wall Thickness \_\_\_\_\_
- Pocket Holes  Yes  No
- Frame Material  PVC White Clad  
 PVC S/S Clad  
 Foamed  
 Stainless Steel

### Options

- Push/Pull Handle  Yes  No
- Handle Package  Plastic Handle  
 Stainless Handle
- Mortise Lock (Stainless Steel)  Yes
- Panic Bar  W/Exterior Access  
 W/Out Exterior Access
- Kick Plate  Yes  No
- Door Closer  Yes  No
- Window  Yes  No
- Size \_\_\_\_\_

### Ordering Information

- Door Number \_\_\_\_\_
- Quantity \_\_\_\_\_
- Job \_\_\_\_\_
- P.O. Number \_\_\_\_\_
- Date Ordered \_\_\_\_\_

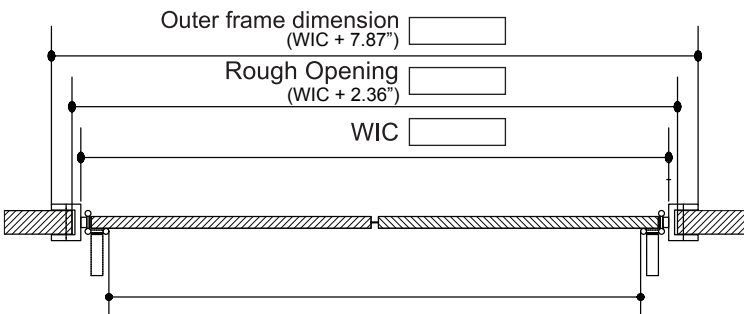

### Changes, Remarks, etc.

<http://www.steelworksandsupply.com>  
Phone: (919) 639 - 3002

\_\_\_ Approved \_\_\_ Approved w/changes (use box if needed)

INSULATED DOORS

Signature \_\_\_\_\_

Date \_\_\_\_\_